

## Complete fit out of new premises for a growing business - Barton Telecom Services



### Who's the customer?

Barton Telecom Services, established 20 years ago and originally based in Wellingborough, are a family run business supplying telephone systems and cabling services to local companies looking to upgrade or going through an office relocation.

### What was the brief?

The customer had been running their successful business from a home office, however an increase in orders and a desire to move the business to a new premises coincided to allow for them to make the move to an empty unit in Earls Barton. The new unit

having all the potential for the business to continue to grow in the coming years.

The empty shell needed to include the following:

- facilities for office space (incl MD office)
- testing area with open windows for fresh air circulation
- secure internal parking area for company van
- ground floor corridor internally to allow for access from front to back



**Barton Telecom Services**

Making space for business to grow

Talk to us on 01933 460422 or visit [www.cubexcontracts.com](http://www.cubexcontracts.com)



This customer needed an empty shell turned into flexible working space



We were recommended to the customer by a mutual contact, and appointed to work on the project after a competing contractor failed to impress them with their lack of knowledge and design skills. The customer was also looking for someone to work closely with them, guiding them through the project and being on hand to explain the processes. In summary, providing a first class service; something we've become known for.

### What was the solution?

Cubex Contracts put forward a plan to maximise space potential and give the customer everything they required, including:

- partitioning on the ground floor which was a fully demountable and reusable system to allow for flexibility to alter as the business grows
- a ground floor corridor designed to allow as much light to flow through it as possible
- as much additional and flexible space as possible
- a small kitchenette area

### About the project

The project was completed in September 2014, and took approximately 3 weeks. Our team of contractors comprised of partition fitters, decorators, ceiling fitters and mezzanine installers who worked along side the customer's own electricians and liaised with them to ensure the project ran smoothly and finished on time.

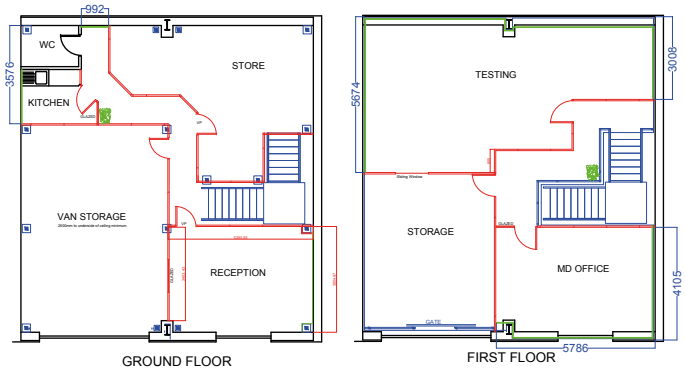

#### ground floor:

- installation of composite partition system to create kitchen, reception area, stores area (or additional office space/ or rest room) and van parking
- ground floor corridor with 45deg scribes and full glass panels to allow flow of light and add interesting feature to an otherwise bland functional space

#### first floor:

- fire protected mezzanine installation (for MD office, testing area and more storage) with full height partitioning between the office and testing area

We also applied for Building Regulations approval, and organised the final inspection on completion of our work.

**Barton Telecom Services**

Making space for business to grow

Talk to us on 01933 460422 or visit [www.cubexcontracts.com](http://www.cubexcontracts.com)



This customer needed an empty shell turned into flexible working space



before



after



before



after



before



after

**Barton Telecom Services**

Making space for business to grow

Talk to us on 01933 460422 or visit [www.cubexcontracts.com](http://www.cubexcontracts.com)